



Point others to Jesus • Love generously and gracefully • Cultivate disciples

Worship Schedule

Sunday Mornings

9:00am Worship

10:00am Education Hour/Fellowship

Wednesday Evening

6:00pm Worship

All Are Welcome!



Christmas Kick-Off Party

Join us on Sunday, December 4 from 2-5pm at PLC for a Christmas kick-off party for all ages. There will be family games, cookies and the Vikings game will be on. Join us for an afternoon of fun for the whole family before the business of the season begins.



You Shop, We Benefit!



For those who are not aware, Teal's Market has a wonderful "1% Receipt Rebate Program." It is an easy way for local non-profits to earn money for their organizations. Simply shop at Teal's Market, bring us your receipts, and we'll earn 1% back on all your qualifying purchases. Paynesville Lutheran Church already utilizes this program, so please bring your receipts from Teal's Market to church and put them in the box in the Gathering Area to help us earn more from this great program.

MEN'S BIBLE STUDY

The Men's Bible study meets on the second and fourth Wednesday of each month at PLC at 9:00am. Join us as we enjoy time together in Bible Study and fellowship.

ONLINE GIVING

TITHES & OFFERINGS

Your support is essential to the mission and ministry of Paynesville Lutheran Church. Consistent giving is a help to this congregation as we plan for ministry expenses throughout the year. If you've found it challenging to give consistently, this may be an opportunity for you to begin doing so. We thank you

in advance for all your continued gifts, financial and otherwise.

Giving online is easy and allows you to set up automatic recurring contributions and view your complete online giving history from anywhere you have access to the Internet. Simply follow these easy steps:

- 1) Visit the church website at www.paynesvill Lutheran.org,
- 2) Click on the "Online Giving" tab on the homepage,
- 3) Click on the "Online Giving" button,
- 4) Follow the onscreen instructions to create an online profile and to schedule your recurring contributions.

You can also contact the church office for a paper form.

November 2022

Sunday	Monday	Tuesday	Wednesday	Thursday	Friday	Saturday
		1 3:00-9:00 Just for Kix	2 3:00pm iQuest 5:20pm Meal 6:00pm Worship Sowers, Confirmation & Sr. High Youth Group following worship 6:45pm CELEBRATION Choir	3	4	5
6 Daylight Savings Time Ends 9:00am worship 10:00am Fellowship/Education Hour	7 12:30pm Quilters 6:00pm Youth & Family Board Meeting	8 3:00-9:00 Just for Kix	9 9:00am Men's Bible Study 3:00pm iQuest 5:20pm Meal 6:00pm Worship Sowers, Confirmation & Sr. High Youth Group following worship 6:45pm CELEBRATION Choir	10 10:00am Women's Bible Study	11 Veterans Day	12
13 9:00am worship 10:00am Fellowship/Education Hour 10:00am Council Meeting	14 12:30pm Quilters	15 3:00-9:00 Just for Kix 7:00pm Trustee Board Meeting	16 3:00pm iQuest 5:20pm Meal 6:00pm Worship Sowers, Confirmation & Sr. High Youth Group following worship 6:45pm CELEBRATION Choir	17 4:30pm Deacon Board Meeting	18	19
20 9:00am worship 10:00am Fellowship/Education Hour	21 12:30pm Quilters	22 3:00-9:00 Just for Kix	23 9:00am Men's Bible Study No iQuest, Sowers, Confirmation or Sr. High Youth Group 7:00pm Thanksgiving Eve Ecumenical Service at PLC	24 Thanksgiving	25	26
27 9:00am worship 10:00am Fellowship/Education Hour 10:00am-Decoate for Christmas	28	29	30 3:00pm iQuest 5:20pm Meal 6:00pm Worship Sowers, Confirmation & Sr. High Youth Group following worship 6:45pm CELEBRATION Choir			

November Birthday Blessings to...

- 2 JoAnn Yarmon, Jeremy Reiter, Lincoln Williams, Bill Amann
- 4 Andrea Guzy
- 5 Vance Utsch
- 6 Brooks Heimerman, Robert O'Fallon
- 7 John Larson, Rowyn Hellermann
- 8 Kaitlin Haase, Paul Shepherd, Allie Stanger
- 9 Alexander Naujokas
- 10 Steve Larson, Garrett Leusink, Ellie Wendroth
- 11 Carol Dreyling, Ashley Eisenbraun, Wyman Nepsund, Kyleigh Tangen, Azalea Utsch
- 12 Kristi Leusink, Arlene Neuman
- 13 Bob Gardner, Melissa Stanley, Vic Wyffels, Brett Lieser
- 14 Bryan Larson, Preston Lieser
- 15 Morgan Soine
- 16 Callie Bennett, Melissa Evans
- 17 Brenda Evans, Deb Heitke,
- 18 Josh Hellerman, Henry Jensen, Ann Larson, Mary Schmidt, Arlene Sullivan
- 19 Jamie Fearing, Easton Anderson
- 20 Logan Klein, Natalie Utsch
- 21 Rick Brady, Leland Kuechle
- 22 Stacy Rindahl, Roni Reiter, Collin Bonnema
- 23 Andrew Hendrickson
- 25 Ross Amundson
- 26 Larry Larsen, Wally Payne, Caroline Stanger, Khloey Kleven
- 27 Nora Ellefson, Sue Stahl, Gerald Meyer, Katie Wendroth
- 29 Taylor Reiter, Grayson Nepsund

Thanksgiving Eve Ecumenical Service Wednesday November 23 - 7:00pm at Paynesville Lutheran Church

You are invited to join us for the annual Paynesville Thanksgiving Eve Worship services at Paynesville Lutheran Church on Wednesday, November 23. Worship will be led by clergy from the Paynesville area and music will be provided by the talented musicians from the area's congregations.



EDUCATION HOUR

We've got a compelling lineup of topics for our upcoming Education Hour at PLC. Our continued goal is to provide meaningful and thought-provoking topics to deepen faith and encourage learning in our community. We'll do this in a variety of ways throughout the year and we hope you'll join in on the learning and growth we'll do together.

Upcoming Topics:

November 6 - Kelley from the ROSE Center
November 13 - Pat Hansen, Friends of the Paynesville Library
November 20 - Stephanie Johnson, Altar Guild
November 27 - Hanging of the Greens

Are You Heading South for the Winter?

If you are planning on going south for the winter please contact the church office as soon as possible. The sooner you are able to contact us the easier it will be to get things forwarded in a timely manner. If you gave us this information last year you still need to let us know so we can verify information.



The Women's Bible study will meet on Thursday November 10, 2022 at 10:00 in the church Chapel. Please bring your copy of the Gather magazine, a Bible and your prayers for those in need. There will be a brief Thankoffering Service, also.

Copies of the Bible study will be available for those who need one. See you November 10.



Share the Warmth Winter Clothing Drive

*Keep others warm this winter season
with clothing donations.*

Items Needed:

*New & Gently Used Coats, Snow Pants,
Boots*

NEW Hats & Mittens

**Items can be dropped off in
the fellowship hall at
Paynesville Lutheran Church**

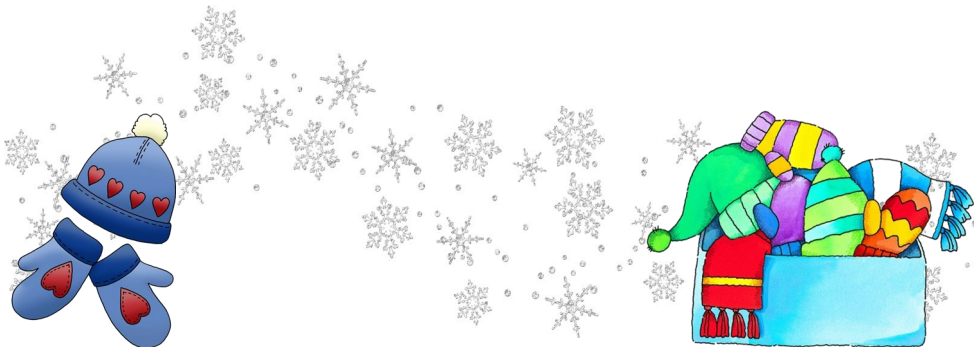

Paynesville Lutheran Columbarium



As a church rooted in the Gospel we seek to minister to all people in every part of their lives. The Columbarium project is one of those ministries. It will provide an opportunity for us to care for people and their families at one of the most tender parts of their journey. Our prayer is that we might be a caring option for family who would like to have themselves or their loved ones interned after cremation right

here at Paynesville Lutheran Church.

As a congregation we have embarked on this ministry after receiving several requests to consider serving others in this way. After our congregational vote to create an eternal resting place through a columbarium we have already received four families that will be utilizing it!

The actual granite columbarium will not be installed at PLC until the late spring of 2023 but if you are interested in learning more or considering this option for you and your family, reach out to the newly created Columbarium committee listed below.

Tom Cremers
Marv Niedan
Rick Hoyne
Bruce Brendal
Darrel Voorhees

	1	2	3	4	5	6
A						
B			(East)	SIDE		
C						
D						

	1	2	3	4	5	6
A						
B			(West)	SIDE		
C						
D						

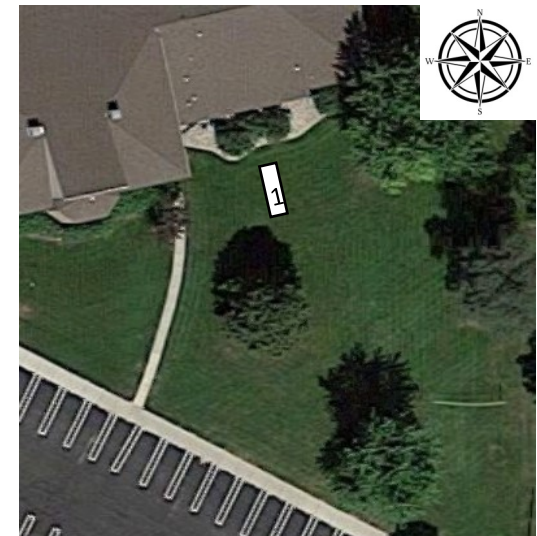

Poinsettias

It is hard to believe that it is that time of year again where we begin planning for the holidays. Again this year you have the opportunity to order poinsettias in memory or in honor of someone for our Christmas Eve Worship Services. Envelopes are available in the gathering area or you can contact the church office to order. **Cost of the poinsettias is \$12.00**
Deadline to place orders is December 5th.



Give the Gift of Warmth

Now that winter weather is here we will be collecting new or gently used hats, mittens and scarves for the Community Service Center. You can place your donations on the tree in fellowship hall beginning the end of November. Thank you for your continuing support of those in our community who need our help.



Be Part of our Memory Tree

Have you ever noticed the different trees that we have around our church building? We always have the "Hat and Mitten" tree where you can bring in new or gently used hats and mittens to share with the Community Service Center. We also have the tree with all the ornaments and paper tags on them. That tree is our Memory Tree. The ornaments on that tree are given in memory of someone who has passed away and the ornaments usually have a special meaning for the family of that person. You can see who each ornament is remembering by looking at the tag connected to each one. As we all know, the holidays can be a difficult time as we remember those who we have lost in the years past. If you would like to share an ornament in memory of someone that you love, please feel free to bring an ornament into the church office and we will get you set up with the tag to attach to the ornament. After Christmas the ornaments will be stored away until next year to be used again. As you notice the unique ornaments on the tree, please take a minute to pray for the families whose loved ones are memorialized on the tree.



Operation Christmas Outreach

We are pleased to announce we will be working with our local Community Service Center again this year for our "Operation Christmas Outreach" November Mission of the Month!

For those of you who are not familiar with Operation Christmas Outreach: This is an outreach project that our entire congregation has embraced. Our mission of the month for November is to raise funds and awareness for those less fortunate; these funds are used to purchase Christmas gifts for teenagers in our community. This is our way of reaching out to our community and being the hands of Christ. What better time of the year to make Him known to others.

We ask that you pray for the teens in our area that will receive the gifts this Christmas season, that our church may make an everlasting impact that shows Christ loves them and has allowed us to share that love with them at Christmas and within our community each day.

We would encourage you to consider making a donation toward this project, you can do this by simply placing funds in an envelope within the offering and noting it is for "Operation Christmas Outreach" or you could mail your donation to church and ensure you mark it accordingly.



Decorating for Christmas!

It's hard to believe November is already here, but at the end of this month it will be time to start decorating our beautiful worship space for Christmas. We will be having our traditional "Hanging of the Greens" after 9:00 am worship on Sunday, November 27. We have lots of trees and spaces to decorate so please plan to stay after worship to help out with this fun event. We always love for families to join us and there is always things for everyone to do from young to old. We will have the Christmas tunes going as well to set the mood for the holidays.



Unique Christmas Gifts

Are you looking for a unique Christmas stocking? Maybe a fun gift bag? How about a warm quilt to wrap up in? The PLC Quilters will be selling these items on Sunday November 27, 2022, the first Sunday in Advent. Please stop by our display table in the Fellowship Hall on November 27th. The proceeds from the sale of these items will go to Operation Christmas.

